

BLUE-WATER SUPERYACHT.

At 55-metre with a steel hull, Project Agnetha is a blue-water ocean-going yacht.

Built to the highest Dutch quality standards, she represents the pinnacle of Heesen's know-how in yacht building. The proven design and engineering platform ensures top performance and maximum comfort in all sea conditions. Her sturdy steel hull is an iteration of van Oossanen Naval Architects' ultra-efficient Fast Displacement hull form, which delivers excellent performance throughout the whole speed range, combining excellent seakeeping and stability with frugal fuel consumption.

With an enclosed volume of 760 GT, Agnetha is big enough to include all the luxury necessities and small enough to enter the charming ports and bays of areas such as Capri and Portofino. Italian design studio Luca Dini Design and Architecture penned a warm interior that exudes discreet luxury through the painstaking quality of the materials and finishes.

Project Agnetha is available for delivery in Q2 2025





With the 7-metre and 6.5-metre tenders and toys conveniently stored on the bow for easy launch and recovery, the transom is home to a spacious beach club that doubles into a wellness area.

FORWARD AREA

Agnetha sits regally on the water, with a stern that looks welcoming when approaching by tender. The fixed swim platform is extremely practical for guests to step aboard comfortably and for quick access to the water as soon as the captain drops the anchor.





The 36 square metres of the transom area are home to a luxurious but functional beach club that doubles as a wellness area with a sauna and a shower. Light settings are customisable and will create the perfect atmosphere. Two floor-to-ceiling slabs of sand-jet finished slabs of Alaska granite embellish the sauna heather corner, while pale and creamy Aspen wood cladding creates a light and modern feeling.

BEACH CLUB

MAIN DECK AFT TERRACE





The Bridge Deck Aft Terrace features a lounge with the iconic sofa Nodi by Tribu. The modular settees allow the owners to rearrange the space to best suit the event they are hosting: from dancing to lounging everything is possible on board Agnetha.

A bespoke teak table for twelve guests is complemented by iconic Arc by Summit dining chairs. A fixed custom buffet on the starboard side is ideal for delivering seamless service for a fine dining experience.

Totem by Dedon lanterns contribute to creating a warm and inviting atmosphere.

AL-FRESCO DINING

The 110 square metres sun deck with the whirlpool adjacent to the bar is undoubtedly the piece de resistance.



SPECS AGNETHA
55M STEEL FDHF
HEESEN SERIES

GENERAL

Yacht number:	20955
Hull type:	FDHF (Fast Displacement Hull Form)
Naval architect:	Van Oossanen Naval Architects / Heesen Yachts
Exterior design:	Omega Architects
Interior design:	Luca Dini Design & Architecture
Classification:	Lloyds 100A1 SSC YACHT LMC, UMS Large commercial yacht code reg-yc
Hull:	Steel
Superstructure:	Aluminium
Delivery:	Q2 2025

PROPULSION DETAILS

Main engines:	2 x MTU 8V 4000 M63 (IMO TIER III) 2 x
Maximum power:	1000kW 2 x ZF 5356 MTU blue vision NG 2 x
Gearbox:	five blade fixed pitch 2 x Zenoro, each 175kW,
Engine control:	50 hertz 1 x Zenoro emergency gen. 80kW ZF-
Propellers:	Marine 125kW, electrically driven Naiad
Main generators:	Dynamics, 2 Fins, Type 720, Zero Speed
Bowthruster:	
Stabilisers:	

DIMENSIONS

Length over all:	
Beam over all:	55 metres / 180 ft 5 inches
Draft:	9.6 metres / 31 ft 6 inches
Displacement:	2.85 metres / 9ft 4 inches.
Tonnage:	Approx. 600 tons (half load) Approx. 760 GT

ACCOMMODATIONS

Crew:	Thir teen
Guests:	Twelve
Cabins:	Full-beam owner's stateroom, one VIP suite, two double guest suites and two twin guest suites.

TECHNICAL DETAILS

Maximum speed:	15.5 knots
Range:	4500 Nautical Miles at 13 knots
Fuel capacity:	100,000 litres / 26,400 US Gallons
Fresh water:	24,000 litres / 6,340 US Gallons

GENERAL ARRANGEMENT

SUN DECK

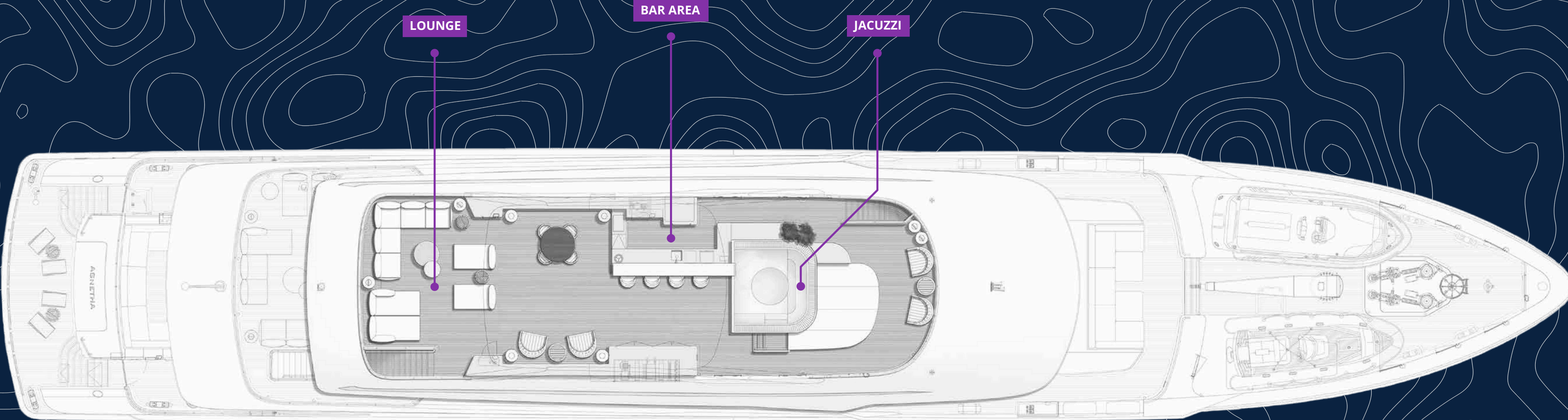

WHEELHOUSE DECK

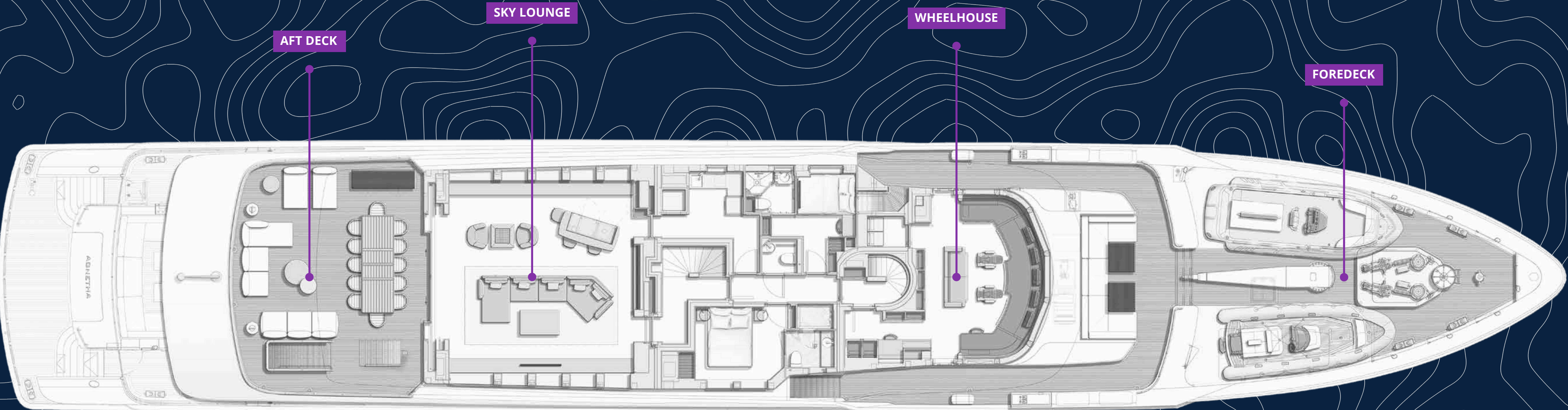

GENERAL ARRANGEMENT

MAIN DECK

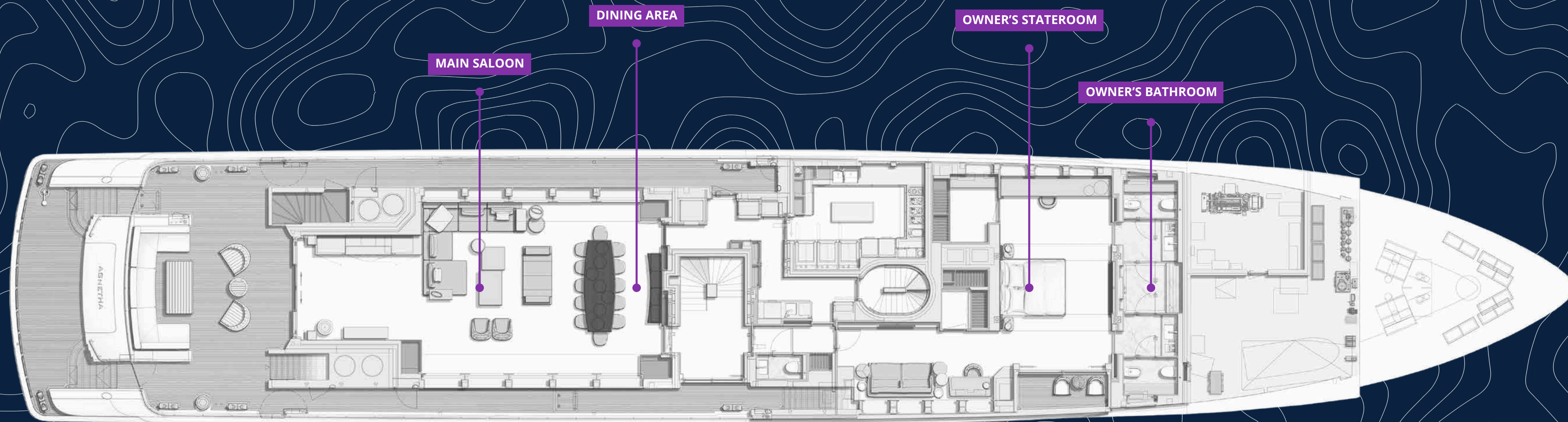

GENERAL ARRANGEMENT

LOWER DECK

BEACHCLUB

ENGINE ROOM

GUEST SUITES

CREW QUARTERS





AGNETHA

WHAT MAKES THIS YACHT
REALLY SPECIAL?

PERFORMANCE

Fast Displacement for economical fuel consumption
Lightweight construction technology

INNOVATION

French balcony for luxurious privacy
Ideal crew routing for seamless service

COMFORT

Fixed swim platform for easy access to the water
Robust Fast Displacement Steel Hull for supreme comfort in all sea conditions

DESIGN

Large whirlpool with integrated bar
Continuous sheets of tinted glass windows accentuate the optical length

The main saloon lounge is at the heart of the indoor social gathering. A large Molteni modular L-shaped sofa faces Gio Ponti armchairs with a contoured backrest for supreme comfort. The iconic daybed Autan by Studio Liaigre completes the set while dividing and uniting the lounge and the dining area.

RADIANT SERENITY

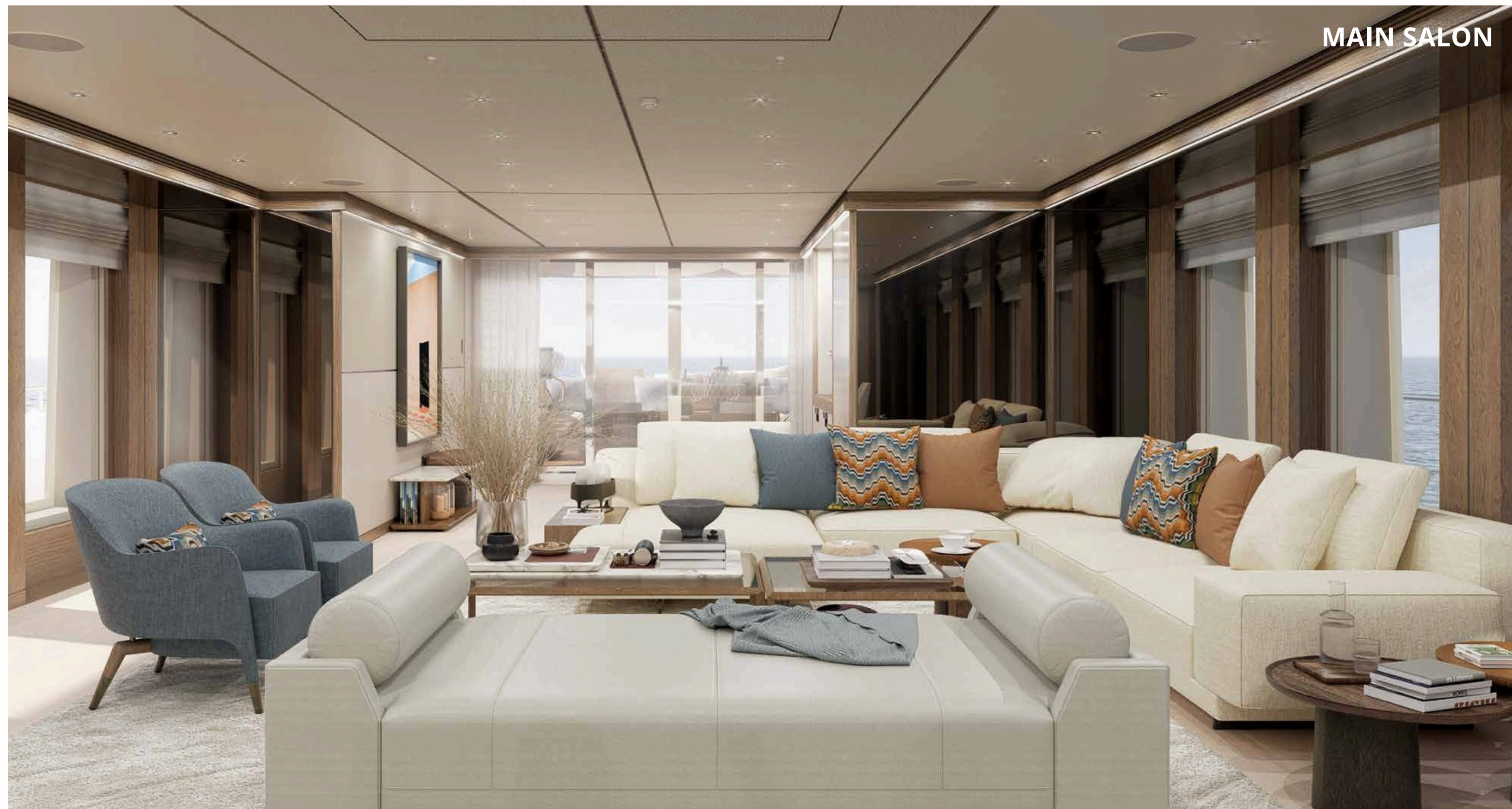



A linear and elegant table by Molteni accommodates twelve guests and is completed by enveloping is-A Dining Chair by Isabella Genovese for Henge. A custom China box trunk-type cabinet is home to numerous table and glassware sets. Floor-to-ceiling windows and open bulwarks offer stunning views of the surrounding nature.

DINING AREA

Party, relax, play, and unwind in the cosiest room on board.
The 60-square-metre sky lounge offers the perfect setting for enjoying cocktails at the full-service bar and playing intense chess matches at the lovely game table by Bassano, which is also equipped for Backgammon, checkers, and dominoes.

SKY LOUNGE





OWNER'S STATEROOM

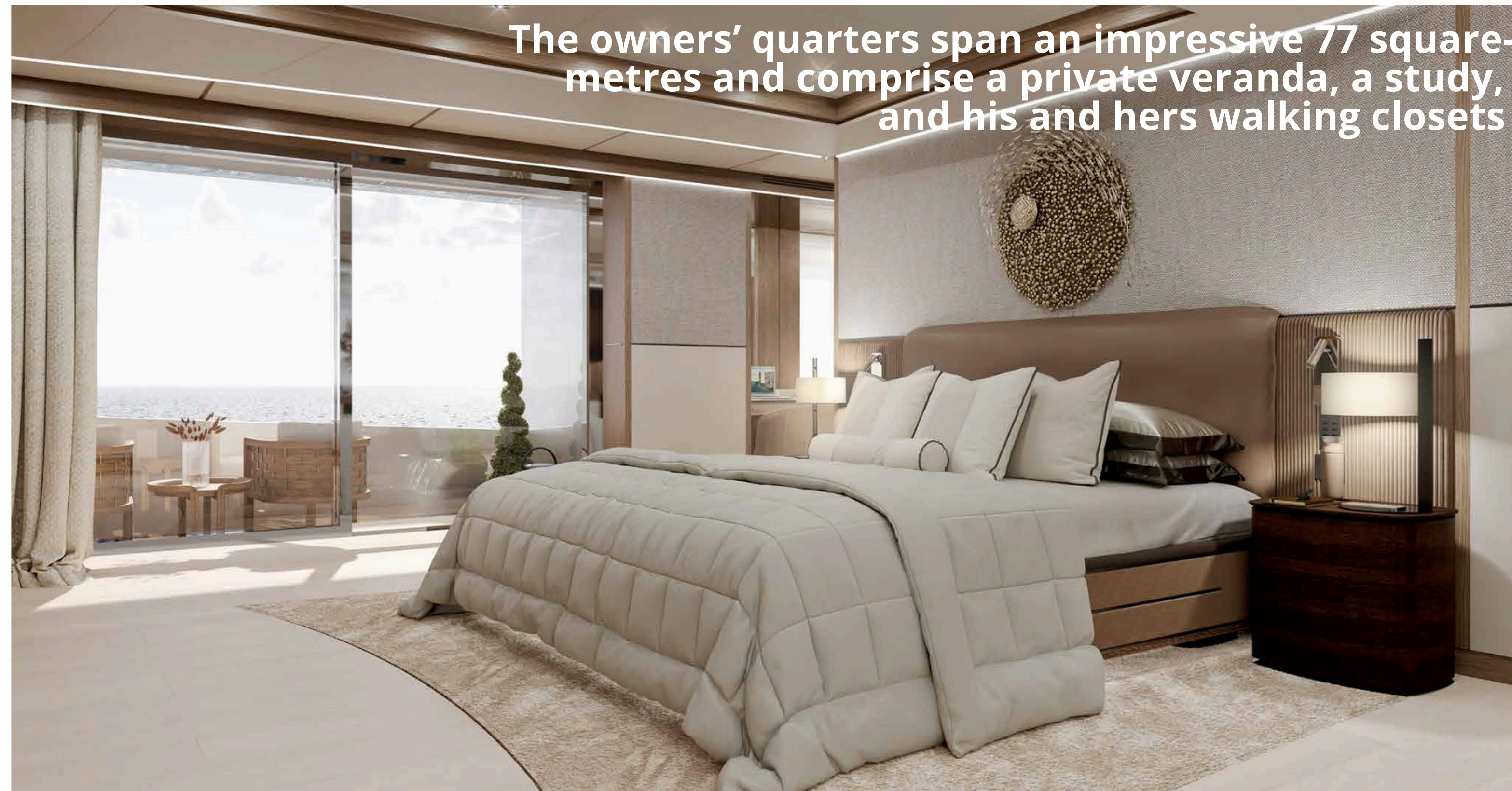

OWNER'S BATHROOM

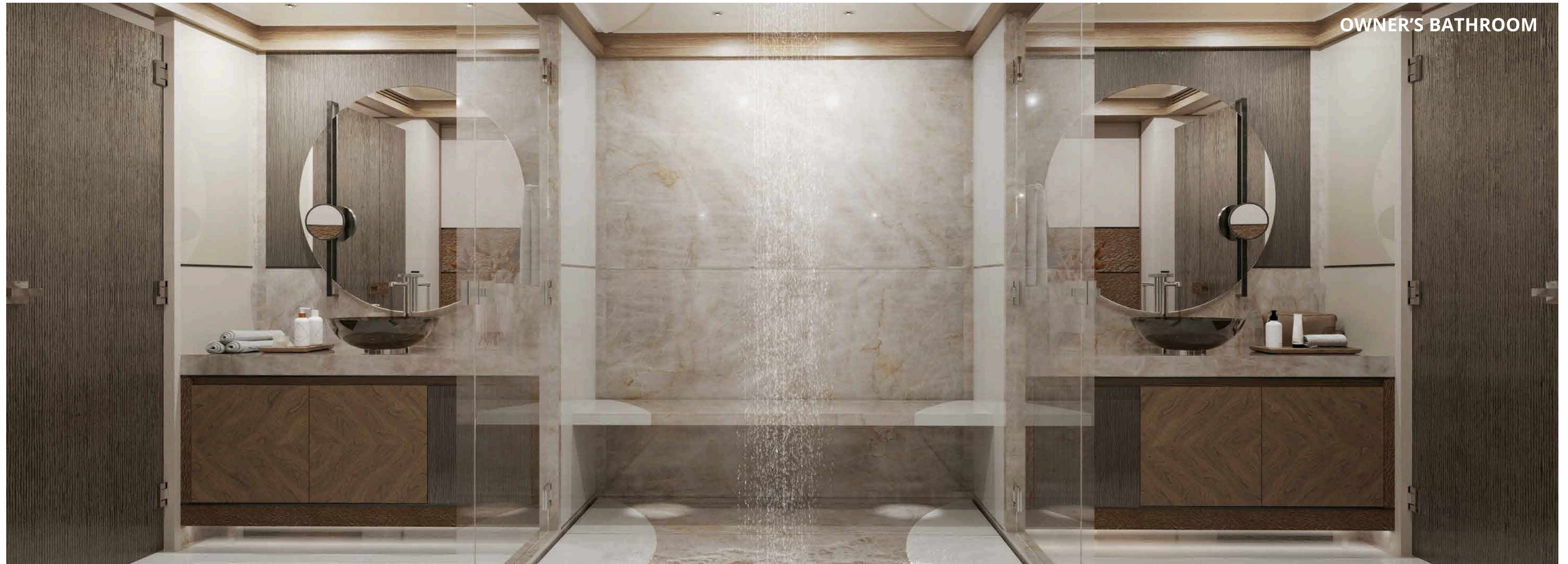

Four spacious guest cabins, two double and two twins, all with private en suite are found on the lower deck. The double cabins with the bed athwart ships offer more room to move around.





TWIN CABIN



**CLASSIC
APPEAL
ORIGINAL
DESIGN**